



DPDT Electromechanical Switch

Pulse Latching, DC to 40 GHz, TTL, 2.92mm, Indicators, D-SUB

Electrical Characteristics:

| Parameter | Condition |
|----------------------------|---|
| Frequency Range | DC-40 GHz |
| RF Impedance | 50 Ohms |
| Operation Mode | Pulse Latching |
| Switch Sequence | Break before make |
| Switching time | 15 ms Max |
| Standard Actuator Life | 2 million Min |
| TTL Voltage | 0-0.8 V(OFF) 2.4-5 V(ON) |
| Actuator voltage Available | 12 24 28 V |
| Actuator current | 400 230 180 mA |
| Indicator Specifications | Max withstand voltage: 60V Max current capacity: 100mA Max "ON" resistance: 16Ω |



RF Specifications:

| Frequency (GHz) | DC-6 | 6-12 | 12-18 | 18-26.5 | 26.5-40 |
|--------------------------|-------|-------|-------|---------|---------|
| Insertion Loss (dB max.) | 0.20 | 0.3 | 0.40 | 0.70 | 1.00 |
| Isolation (dB min.) | 70 | 70 | 60 | 55 | 50 |
| VSWR (max.) | 1.3:1 | 1.4:1 | 1.5:1 | 1.7:1 | 2.0:1 |
| RF Power CW (Watts max.) | 80 | 50 | 45 | 15 | 8 |

Environmental And Physical Characteristics:

| Parameter | Condition |
|-----------------------|---|
| Operating Temperature | -25°C to +65°C (Standard) -55°C to +85°C (Optional) |
| Vibration (operating) | 10G RMS, 20-2000HZ |
| Shock (non operating) | 50G, 1/2 Sine, 12msec |
| Connector Type | 2.92mm Female |
| Control Connector | D-SUB 9PIN Male |
| Weight | 125g Max |



DPDT Electromechanical Switch

Outline Drawing:

Unit: Inch(mm)

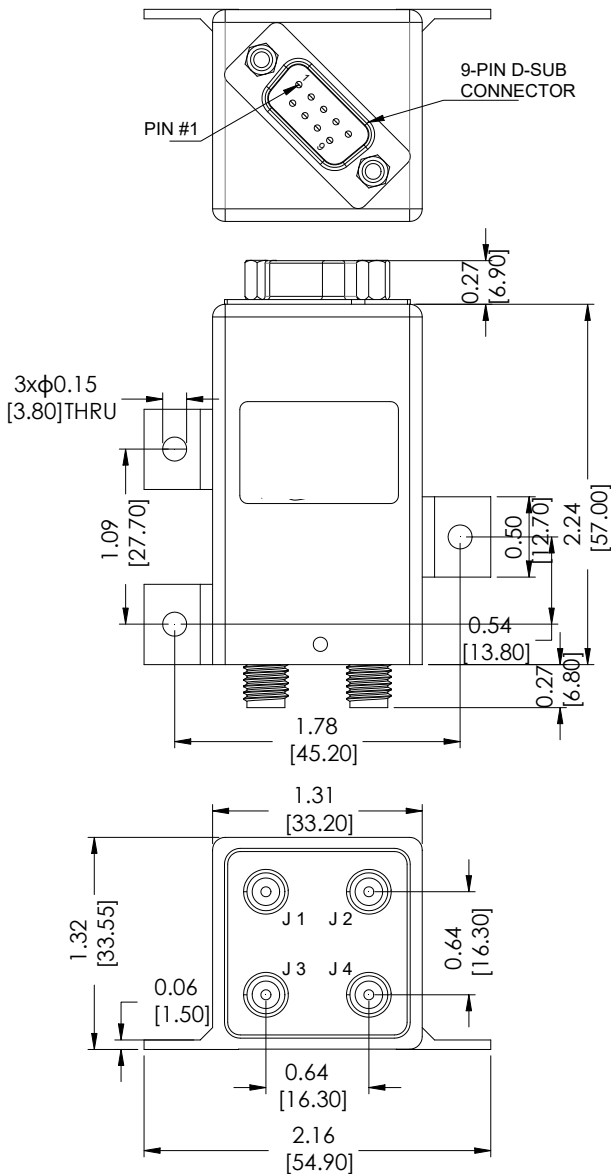

Schematic:

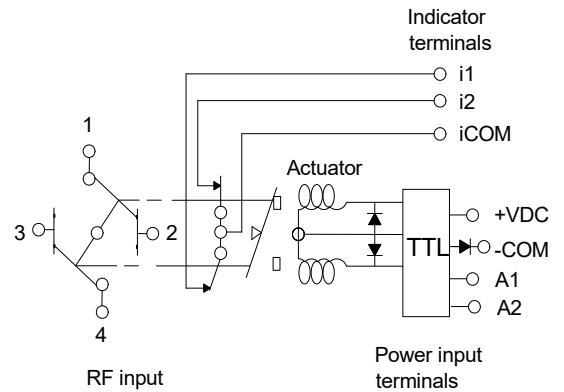

| 9 PIN D-SUB | | RF Connect Used |
|-------------|----------|------------------|
| Pin NO | FUNCTION | DPDT |
| 1 | A1 | POS1:J1-J3,J2-J4 |
| 2 | A1 | POS2:J1-J2,J3-J4 |
| 3 | -COM | |
| 4 | NC | |
| 5 | i1 | |
| 6 | i2 | |
| 7 | iCOM | |
| 8 | NC | |
| 9 | +VDC | |

Outline Drawing:

| Model | Actuator voltage | Option |
|----------------|------------------|-------------------|
| R22-KL12T40-DI | 12 V | -S(-55°C - +85°C) |
| R22-KL24T40-DI | 24 V | |
| R22-KL28T40-DI | 28 V | |



DPDT Electromechanical Switch

Typical Performance Data:

VSWR

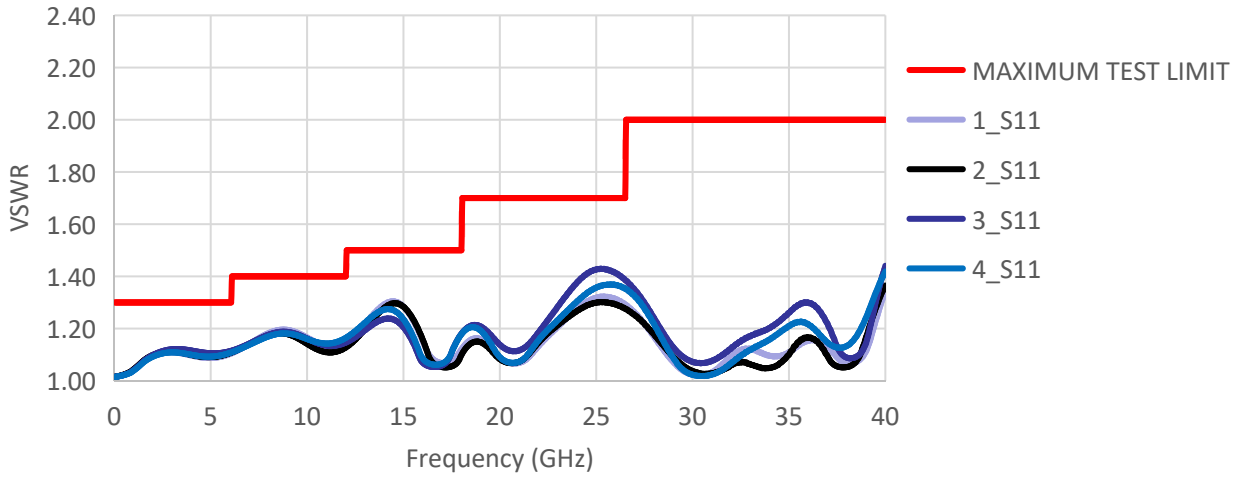

INSERTION LOSS

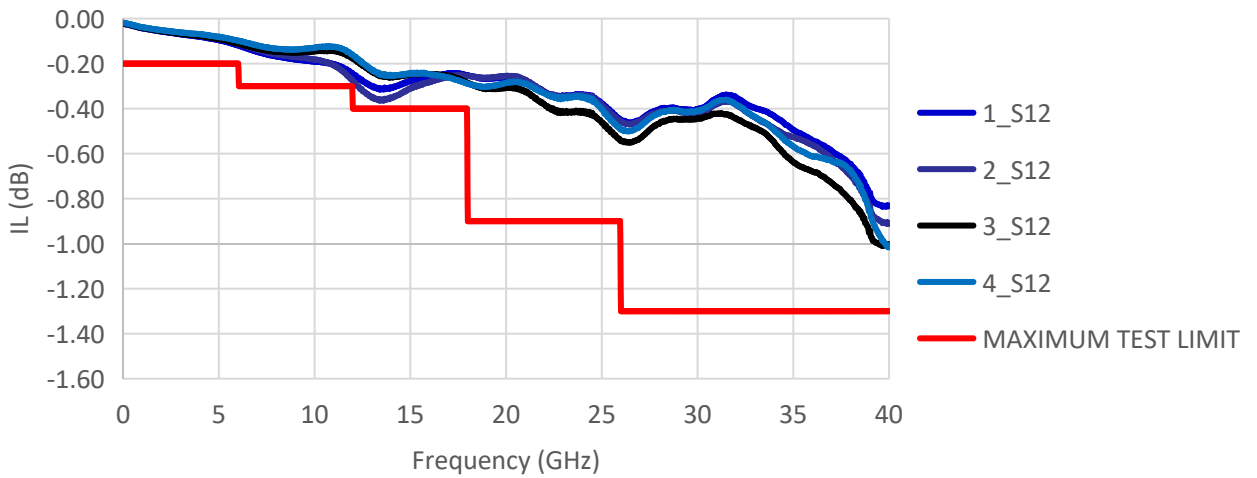

ISOLATION

